



**Murray Avenue**  
Kingsley, Northampton

**oriordanbond**  
SALES & LETTINGS



## Murray Avenue

Kingsley

NN2 7BS

PRICE £220,000

O'Riordan Bond is delighted to offer for sale this impressive double bay fronted two bedroom end terraced property, situated in a popular cul-de-sac within Kingsley, just a short walk away from the Racecourse Park.

The accommodation comprises entrance hall, sitting room, fitted kitchen/dining room, two first floor double bedrooms and a recently re-fitted shower room. Outside is a walled front garden and a reasonable size garden to the rear plus a double garage with inspection pit accessed via a rear service road. Further benefits include gas radiator heating and uPVC double glazing. (B/733/M)

### Additional information

- Council Tax Band: B
- Energy Efficiency Rating:

### Viewing

Viewing strictly by appointment – details below

### Disclaimer

O'Riordan Bond Estate Agents Limited has not tested apparatus, equipment, fittings or services and so cannot verify they are in working order. The buyer is advised to obtain verification from their solicitor or surveyor.

O'Riordan Bond Abington Sales

01604 639007

abington@oriordanbond.co.uk

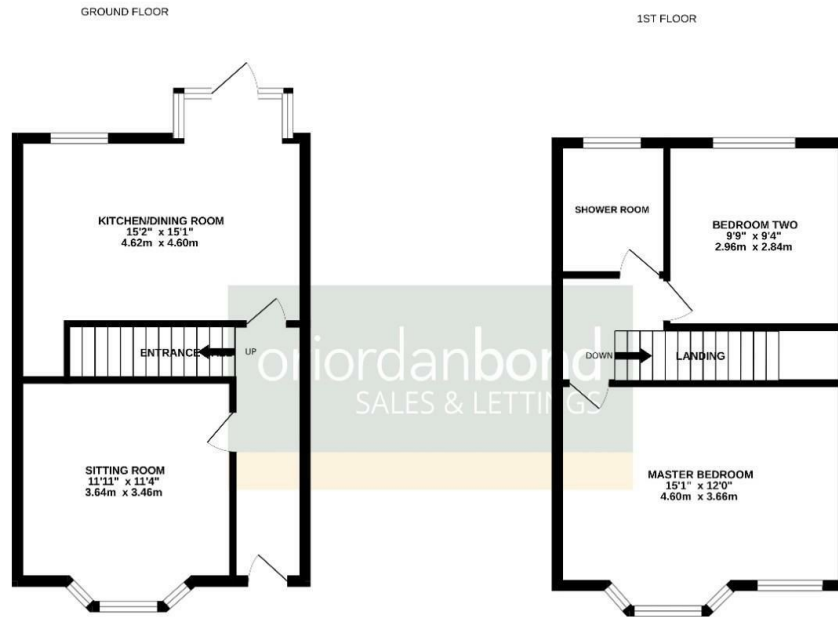

TOTAL FLOOR AREA: 733 sq.ft. (68.1 sq.m.) approx.

Whilst every attempt has been made to ensure the accuracy of the floorplan contained here, measurements of doors, windows, rooms and any other items are approximate and no responsibility is taken for any error, omission or mis-statement. This plan is for illustrative purposes only and should be used as such by any prospective purchaser. The services, systems and appliances shown have not been tested and no guarantee as to their operability or efficiency can be given.

Made with Metropix ©2026